

# nestegg®

FOR YOU AND YOUR CHILD'S SAFETY PLEASE READ  
THE FOLLOWING INSTRUCTIONS CAREFULLY.

Congratulations on purchasing your new **bushbaby nestegg** the most innovative child cot available. **nestegg** has been designed to be light to transport, easy to put up and give maximum child comfort.

Please be very careful when opening your nestegg. The cot is made using 'sprung steel hoops' which are under tension when packed and can open out with force.

## MATTRESS INSTRUCTIONS

### To inflate:

Open the air valve and allow to inflate. Zip into base of nestegg through the sleep sheet found around the inside of the **nestegg**. Once fully inflated tighten the valve, extra air can be added if necessary.

### To deflate the mattress:

Undo the air valve and roll the mattress from the opposite end, this may be easier done on the floor by kneeling on it and squeezing the air out as you go. When all the air is squeezed out tighten the air valve to stop it re-inflating. Fold the mattress into four and place in the zip bag provided.

## WARNINGS

The **nestegg** is only ready for your child, once the mattress has been inserted below the sleep sheet in the base.

Do not use **nestegg** on a surface above floor level.

For the comfort of your child please ensure the surface on which you wish to place your **nestegg** is free from uneven and sharp objects.

Never leave your child unattended at any time when using **bushbaby nestegg** if side entrance is open.

This product is made from flame retardant fabric but should be kept away from fire and other heat sources. The product may burn if left in contact with a direct flame source.

PLEASE SEE OTHER SIDE FOR INSTRUCTIONS ON HOW TO PACK YOUR NESTEGG AWAY

Additional or replacement parts should only be obtained directly from Bushbaby or via a recommended retailer.  
For more information please call : +44 (0) 161 474 7097

Bushbaby® PO Box 61, Stockport, Cheshire, SK3 0AP  
Tel. +44 (0) 161 474 7097 Fax. +44 (0) 161 476 2647 sales@bush-baby.com www.bush-baby.com



# nestegg®

**IMPORTANT, PLEASE READ THESE INSTRUCTIONS.**

There is only one way to fold a nestegg correctly. Please study these instructions carefully. If you force the metal frame you will damage the nest egg.

**YOU WILL NEED TO REMOVE THE MATTRESS BEFORE BEGINNING THE PROCESS.**

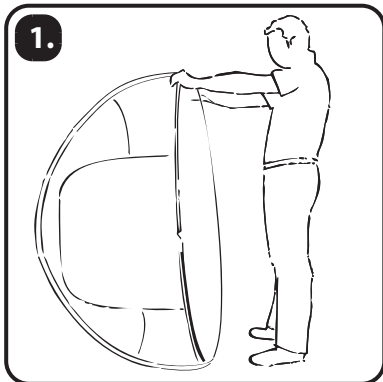

1. Close all zips and turn the nestegg vertical, with the base facing you.

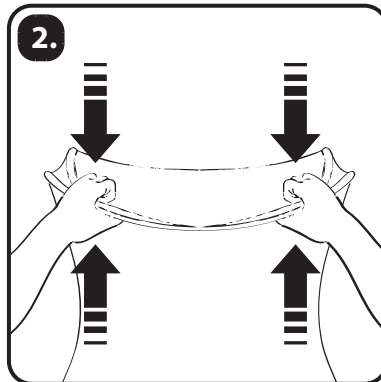

2. Hold the metal either side of the cross-over pulling the metal ribs together.

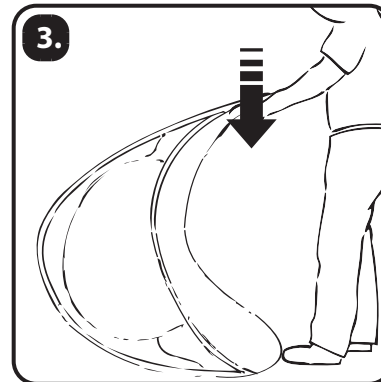

3. Put your foot on the base. Fold the top cross-over down towards the floor. Ensuring the metal does not kink.

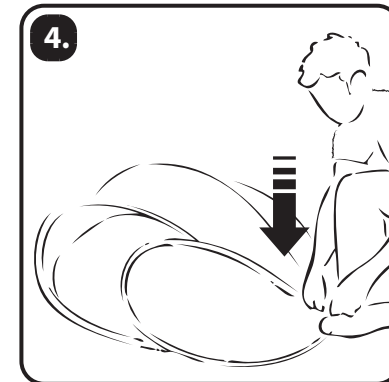

4. Bend down and keep hold of the cross-over in your right hand.

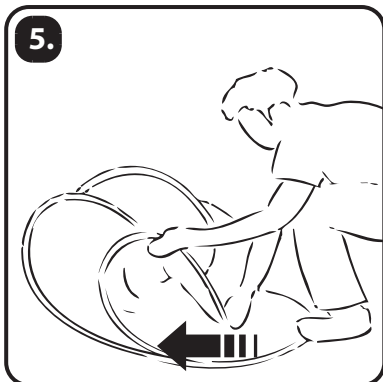

5. Push the cross-over away from you in a straight line for 40-50cm until the metal loops start to fold.

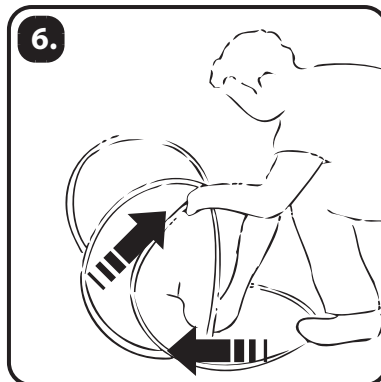

6. Continue to push the cross-over away and gather in the loops with your left hand.

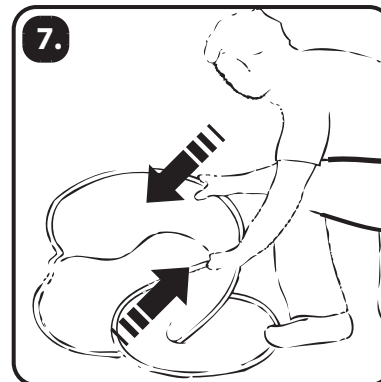

7. The left side will drop flat underneath the righthand side.

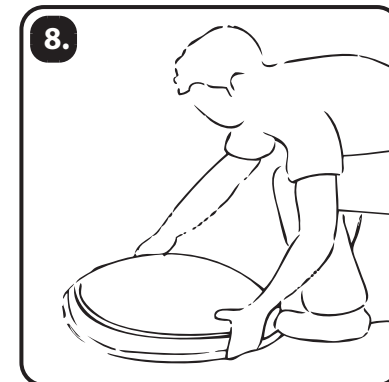

8. Finally shape the nestegg into a round shape and place inside the bag.